

Fire Procedure for the Kings Meadow Campus

Fire Alarm



Is a Continuous Siren

Tested on **Friday** mornings

Raising the Alarm

If you locate a fire or smell smoke you must raise the alarm by breaking the glass of the nearest fire alarm call point

Break Glass



Passing on Information

Exact details of the fire **MUST** be reported to University security, giving details of the location and nature of the fire.

This is very important if a false alarm has been triggered

Dial 8888
Mobile 01159518888



Hearing the Alarm

Evacuate the building by the nearest exit, closing all doors and windows behind you.

Do **NOT** use the lifts or stop to collect personal belongings.



Evacuation Procedure

Proceed to the assembly point located at the rear of the building

The designated Fire Officer or Emergency Services Coordinator will instruct you when it is safe to re enter the building.

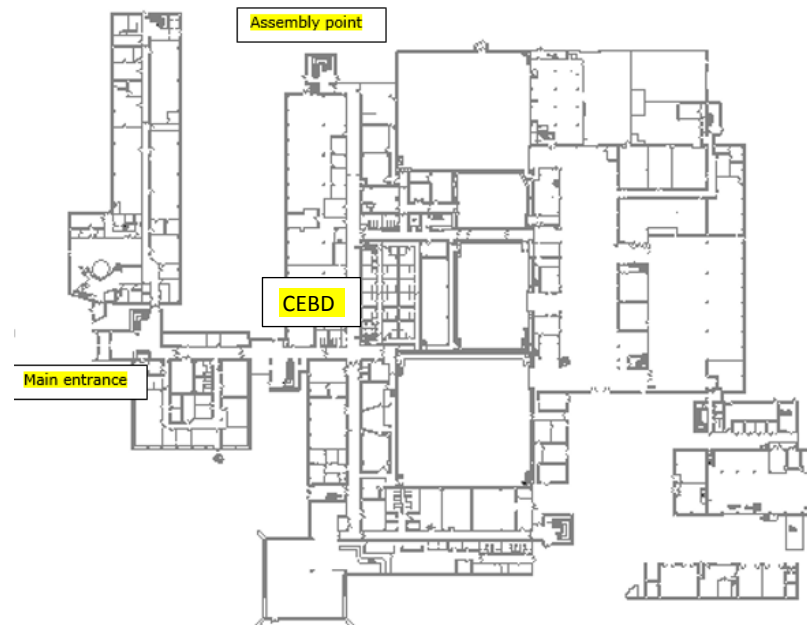

Fire Fighting

Only tackle the fire if it is safe to do so, and you have been trained

